

Building Sketch

Borrower/Client				
Property Address 610 Caswell Rd				
City	Chapel Hill	County	State	Zip Code
Lender				

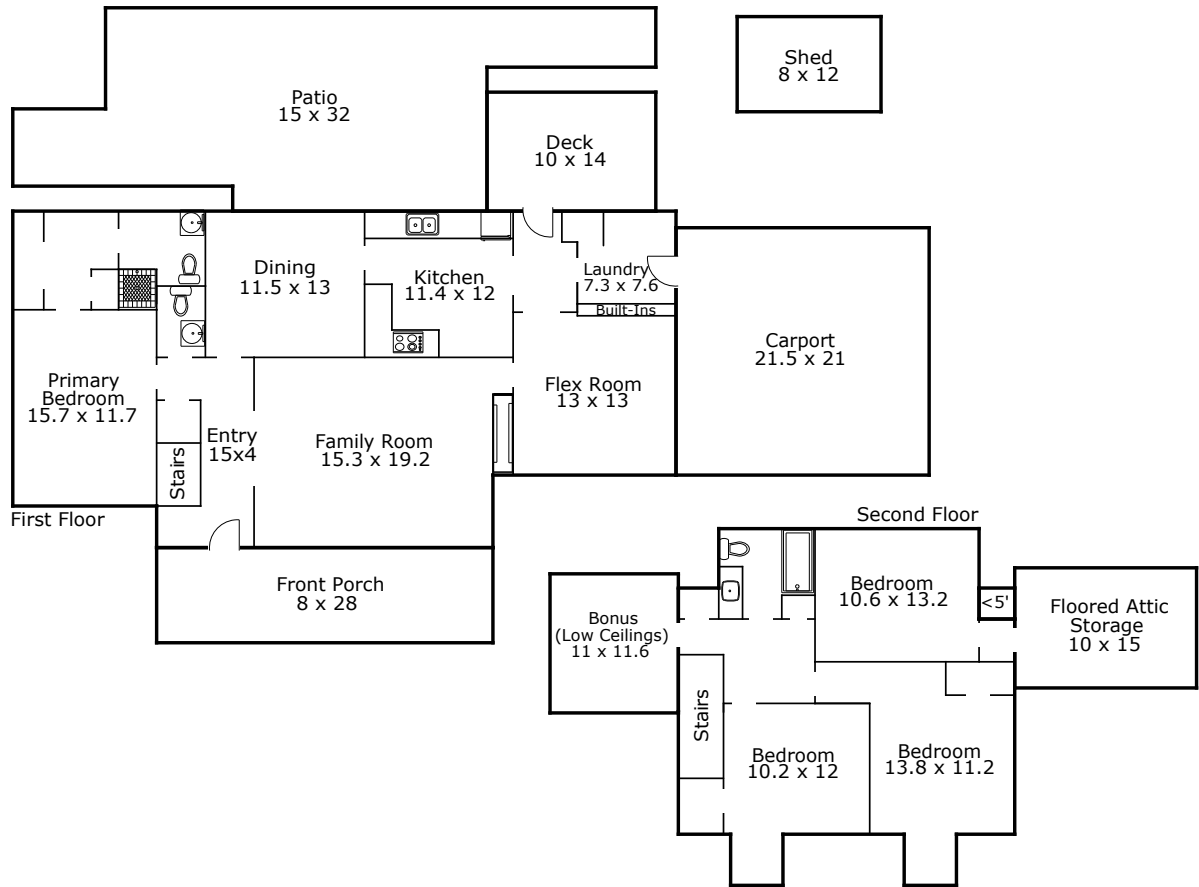

TOTAL Sketch by a la mode

Area Calculations Summary

Living Area	
First Floor	1442.8 Sq ft
Second Floor	725.3 Sq ft
Total Living Area (Rounded):	2168 Sq ft
Non-living Area	
Second Floor (low ceilings)	126.4 Sq ft
Deck	142 Sq ft
Shed	96.8 Sq ft
Carport	443 Sq ft
Patio	648.1 Sq ft
Floored Attic Storage	154.5 Sq ft
Area Under 5'	7.8 Sq ft
Front Porch	226.4 Sq ft