

TOTAL Sketch by a la mode

Area Calculations Summary

Living Area		Calculation Details
First Floor	2315.66 Sq ft	$40.3 \times 57.2 = 2305.16$ $3.1 \times 2 = 6.2$ $0.5 \times 2 \times 2.3 = 2.3$ $0.5 \times 2 \times 2 = 2$
Total Living Area (Rounded):		2316 Sq ft
Non-living Area		
Front Porch	457.6 Sq ft	$8 \times 57.2 = 457.6$

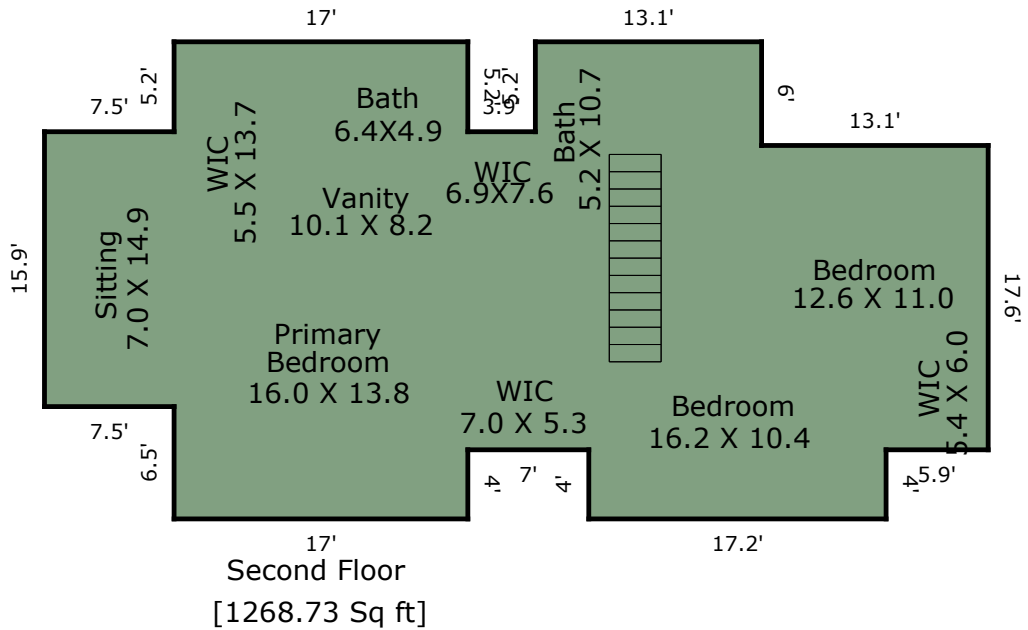

TOTAL Sketch by a la mode

Area Calculations Summary

Living Area	Calculation Details	
Second Floor	1268.73 Sq ft	$17.2 \times 4 = 68.8$ $15.9 \times 7.5 = 119.25$ $27.6 \times 17 = 469.2$ $17.6 \times 13.1 = 230.56$ $17 \times 18.4 = 312.8$ $5.2 \times 13.1 = 68.12$
Total Living Area (Rounded):	1269 Sq ft	

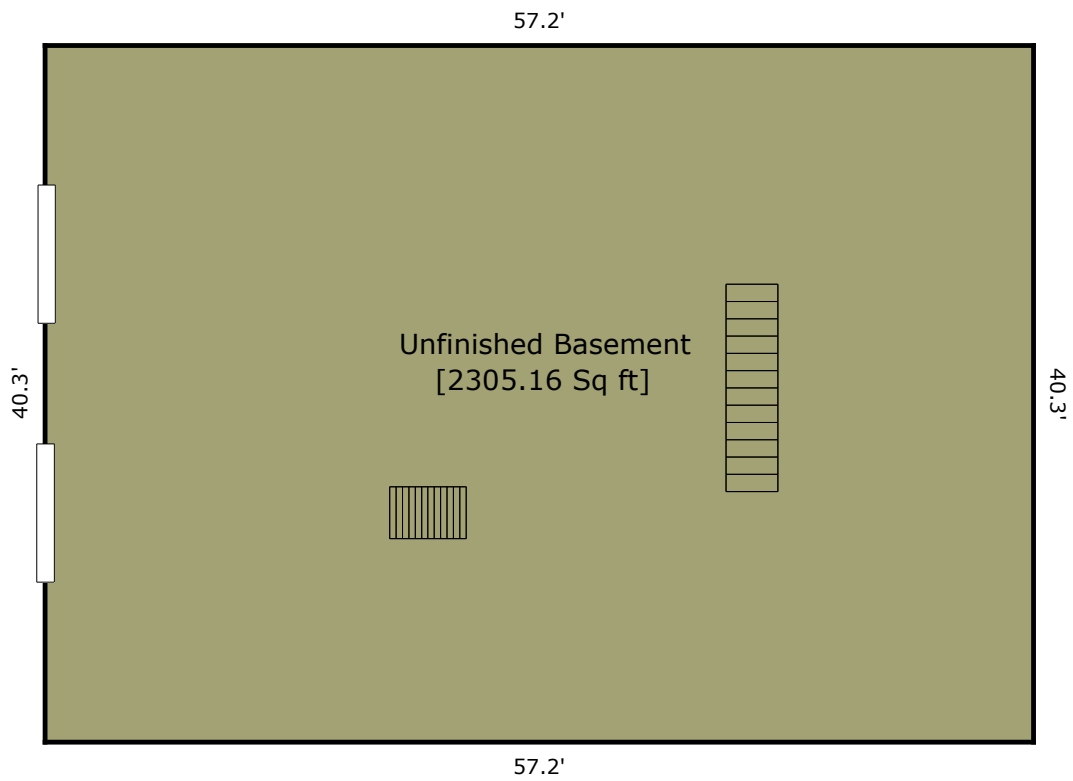

TOTAL Sketch by a la mode

Area Calculations Summary

Non-living Area

Basement	2305.16 Sq ft	$40.3 \times 57.2 = 2305.16$
----------	---------------	------------------------------

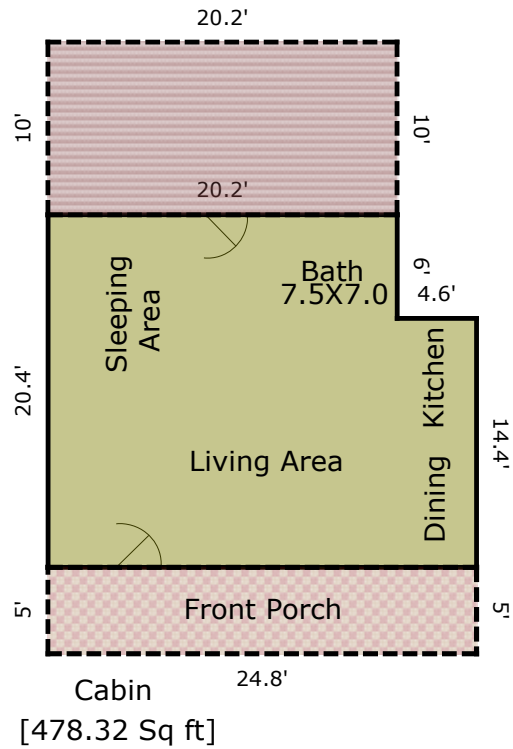

TOTAL Sketch by a la mode

Area Calculations Summary

Non-living Area

Patio	124 Sq ft	$5 \times 24.8 =$	124
Wood Deck	202 Sq ft	$20.2 \times 10 =$	202
Cabin	478.32 Sq ft	$20.4 \times 20.2 =$	412.08
		$4.6 \times 14.4 =$	66.24

10.4 ft Lean to

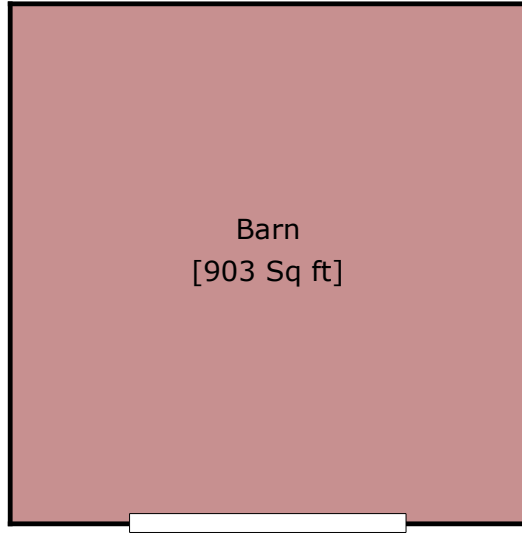

TOTAL Sketch by a la mode

Area Calculations Summary

Non-living Area

Barn	903 Sq ft	$30.1 \times 30 = 903$
------	-----------	------------------------